

ITEM	PART #	DESCRIPTION	QTY	ITEM	PART #	DESCRIPTION	QTY
01	PA1188	30" SS TURBINE POWDERCOATED	1	21	P62025	ADAPTER	2
02	PA1901	SHAFT KEYED	1	22	P62179	1/8" COPPER TUBE	2.5
03	PA1035	MACHINED FLANGE BEARING	2	23	P62026	ADAPTER	1
04	P44021	ADAPTER SLEEVE	2	24	P12042	GREASE ZERK	2
05	P44071	BEARING INSERT	2	25	PA1834	BOOM C/W TEFLON NOZZLE	1
06	PA1424	30" POWDER COATED FAN	1	26	P9874	2" FEMALE SS CAM LOCK	2
07	PA1419	FAN NOSE CONE POWDERCOATED	1	27	P9873	2" MALE SS CAM LOCK	1
08	PA1059	TEE HANDLE PAINTED	1	28	P55198	2" SS ELBOW, 316	1
	PA1057	TEE HANDLE POWDERCOATED	1	29	PA1403	TOP SAFETY SUPPORT (INCLUDES 30 - 34)	1
09	PA1200	CLAMP RING PAINTED	1	30	P76031	1/2" SS 316 NC NUT	7
	PA1196	CLAMP RING POWDERCOATED	1	31	P76015	1/2" SS 316 FLAT WASHER	34
10	PA1032	OUTLET TUBE PAINTED	1	32	P44111	5/8" BEARING	2
	PA1018	OUTLET TUBE POWDERCOATED	4	33	P76035	1/2" X 2" SS 18.8 CARRIAGE BOLT	2
11	P76005	8 X 1/2 SS SCREW	4	34	P76016	1/2" SS 316 LOCK WASHER	25
12	P76025	1/2 X 1 3/4 SS 316 NC BOLT	8	35	PA1426	BOTTOM SAFETY BRACKET (INCLUDES 36 - 41)	1
13	P48104	WOODS COUPLER	1	36	P76006	5/8" SS 316 NUT	4
14	P48103	WOODS INSERT	1	37	P76004	5/8" SS 316 LOCK WASHER	8
15	P48105	WOODS COUPLER } 40 HP MOTOR	1	38	P76002	5/8" SS 316 FLAT WASHER	1
16	P63020	200 LB STAINLESS PRESSURE GAUGE	1	39	P76040	5/8" SS 316 JAM NUT	1
17	P81171	5/16" X 3/8" KEYSTOCK	1	40	P49080	4" CASTER STYLE WHEEL	2
18	P76017	SS 316 INTERNAL TOOTH LOCK WASHER	3	41	P76034	5/8" X 4" SS 316 BOLT	1
19	P23166	TEFLON SPIRAL NOZZLE	30				
20	P76022	3/8 X 1 3/4 SS 316 NC BOLT	3				

DETAIL B
ITEM #29

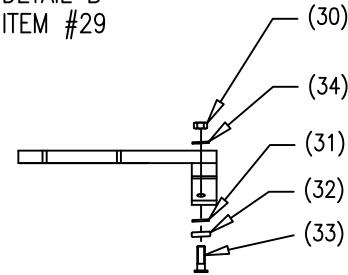

DETAIL A

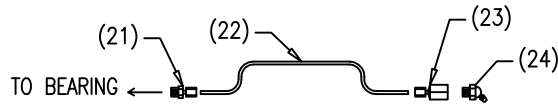
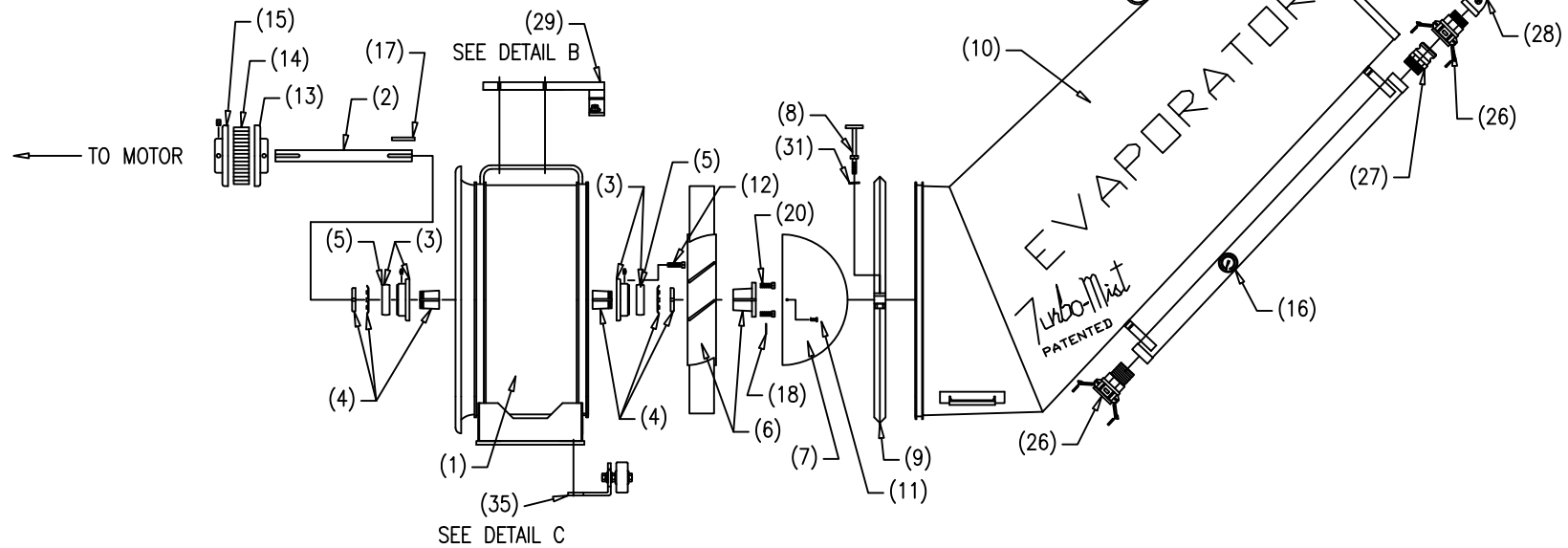
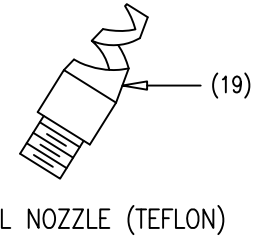

FAN BEARING LUBRICATION (2PCS)
ONE PC. AT 15"
ONE PC. AT 21"

DETAIL C
ITEM #35

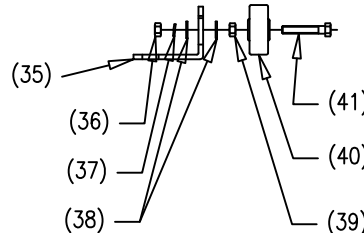

02	021	'PAINTED' OPTION REMOVED FROM ITEM 01. 'P' WAS ADDED AT THE BEGINNING OF EACH PART NUMBER	ML	KB	13/01/11
01	-	FIRST RELEASE	GDS	-	01/02/02
REV	ECD	DESCRIPTION OF CHANGE	DRN	APP	DATE

**SLIMLINE
MANUFACTURING
LTD.**

559 OKANAGAN AVE. E.
PENTICTON, B.C.
CANADA V2A 3K4
BUS (250) 493-6145
FAX (250) 492-7756

Project Name
**TURBO-MIST
EVAPORATOR**
230/440/480/575 VOLT

Date
01/02/02

Dwg#
PAR-00058

REV
02

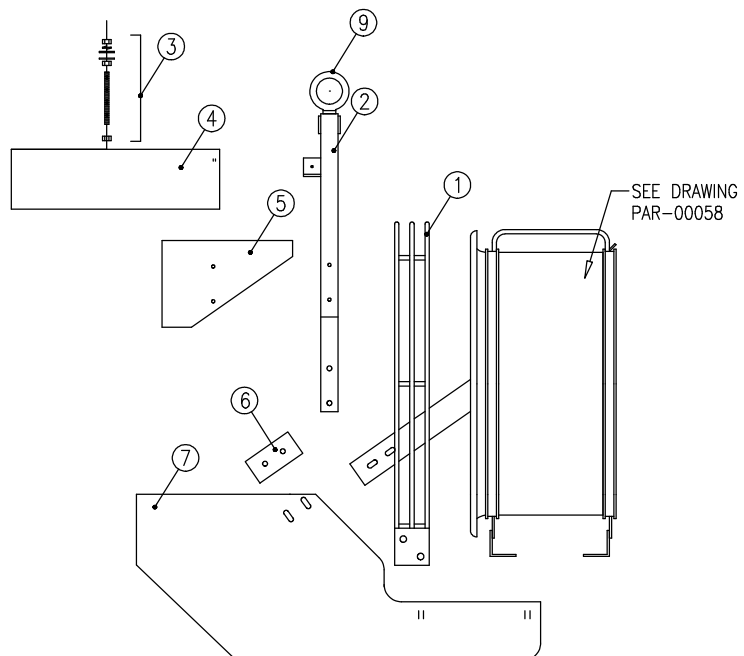
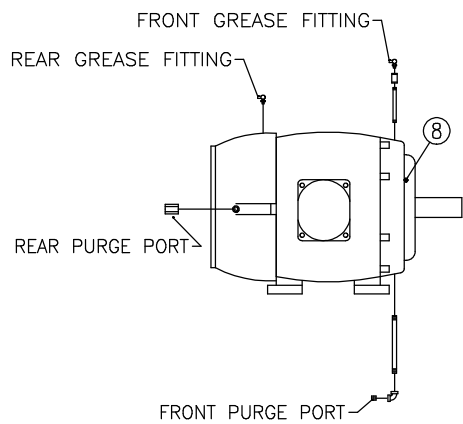

ITEM	PART #	DESCRIPTION	QTY
1	A1002	EVAP, HOOD PAINTED	1
	A1001	EVAP, HOOD POWDERCOAT	1
2	A1150	EVAP, LIFT ASSY PAINTED	1
	A1133	EVAP, LIFT ASSY POWDERCOAT	1
3	NPN	1/2 SS BOLT COVER FASTENER	1
4	A1644	EVAP, HOOD SS MOTOR COVER	1
5	A1642	EVAP, SS SHAFT COVER	1
6	A1942	EVAP, BOLTING PLATE PAINTED	2
7	A1294	EVAP, MOTOR MOUNT PAINTED	1
	A1247	EVAP, MOTOR MOUNT POWDERCOAT	1
8	55471	MOTOR 40HP 460V 60C	1
	55469	MOTOR 40HP 575V 60C	1
	55456	MOTOR 40HP 380V 50C	1
	55488	MOTOR 40HP 230V 60C	1
9	12012	EYE, BOLT 3/4X2	1

SLIMLINE
MANUFACTURING
LTD. 559 OKANAGAN AVE. E.
PENTICTON, B.C.
CANADA V2A 3K4
BUS (250) 493-6145
FAX (250) 482-7756

Project Name
S30 EVAPORATOR
PARTS
Date 24/03/98 Dwg# PAR-00095

S:\ENGINEERING\DRAWINGS\PARTS\PAR-00095.DWG

REVISED: 17/01/02